



LINK

we link the world

BAĞLANTI VE DİŞLİ AKSESUARLAR *Connection & Threaded Accessories*



BAĞLANTI VE DİŞLİ AKSESUARLAR

Bu bölümde önerilen bağlantı ve dişli aksesuarlar askı rotlarının kirişlere, betona veya diğer yapı elemanlarına kaynak civata ile bağlanarak zaman kazanılması amacı ile dizayn edilmiştir. Değişik uygulamalar için çok çeşitli modeller bulunmaktadır.

Malzemeler:

Bağlantı & Dişli Aksesuarlar üretiminde çelik, dökme demir ve dövme demir kullanılmıştır. Diğer malzemeler ile de üretim yapılabilir.

Kaplamalar:

Mekanik desteklerin standart kaplamaları üretimden sonra Sıcak Daldırma Galvaniz (EN 1461) ve Elektro Galvaniz (EN ISO 2081) kaplanmalıdır. İsteğe bağlı olarak diğer özel kaplamalar uygulanabilir.

Onaylar (Belirtilen) :

TSEK ve ISO 9001 : 2008, OHSAS:18001:2007, ISO 14001:2004 Sistemlerinde belirtilen şartlarda üretilmiştir. Tüm modellerin GOST K, GOST R VE SEPRO Sertifikası mevcuttur.

Bu bölümde yer alan bütün boru ve askı destek sistemleri aksi belirtilmediği sürece TS 301/1-2-3-4, TS 1997, TS 416, DIN 2440-2441, DIN 1626, ISO 65, BS 1387, ASTM A-53, NFA 49-145, UNI 8863 uluslar arası standart borular için boyutlandırılmıştır. Bazı çelik ürünler diğer boru çaplarını karşılamak için özel olarak üretilebilirler, örnek olarak pik boru, pvc boru vb.

CONNECTION & THREADED ACCESSORIES

Connection & Threaded Accessories offered in this section are designed to suspend rods from beams, concrete and other structural surfaces by bolting or welding and to reduce installation time. A wide range of types and sizes are available for various applications.

Materials:

Carbon Steel, Malleable Iron and Forged Steel are used in the manufacturing of connection & threaded accessories and provide the high strength properties required. Other materials are available.,

Finishes:

The standard finishes for mechanical supports are hot-dip galvanized after fabrication (EN 1461) and Zinc Plated (EN ISO 2081). Other special coatings are available upon request.

Approvals (as noted):

Manufacturing is controlled by TSEK, ISO 9001:2008, OHSAS 18001:2007, ISO 14001:2004 System Standards. All products have GOST K, GOST R and SEPRO certification.

All pipe hangers and support in this section are sized to feet schedule 40/80, TS 301/1-2-3-4, TS 1997, TS 416, DIN 2440-2441, DIN 1626, ISO 65, BS 1387, ASTM A-53, NFA 49-145, UNI 8863 Pipe standards unless otherwise noted. Some steel items may be specially fabricated to fit other pipe diameters i.e. ductile iron, etc.

TRB
Sayfa / Page: 182

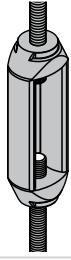

FSC
Sayfa / Page: 182

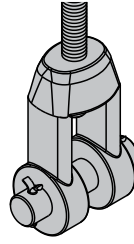

MCDH
Sayfa / Page: 183

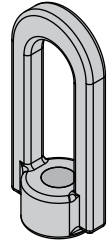

CRAP
Sayfa / Page: 184

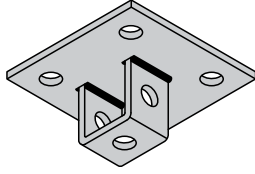

CRBP
Sayfa / Page: 184

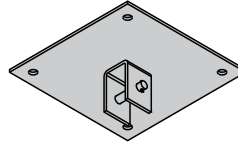

CSLP
Sayfa / Page: 185

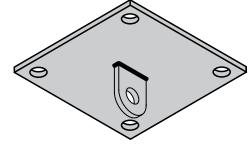

PLSP
Sayfa / Page: 185

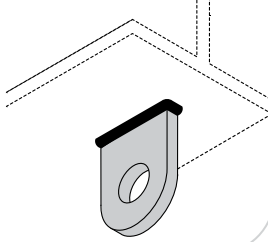

IUL
Sayfa / Page: 186

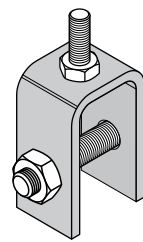

LUP
Sayfa / Page: 186

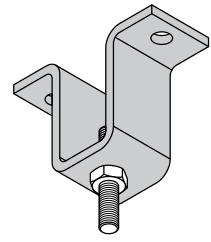

AYBF
Sayfa / Page: 187

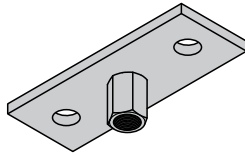

LPK
Sayfa / Page: 187

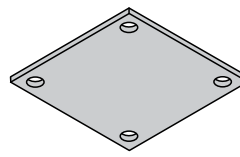

YDRB
Sayfa / Page: 187

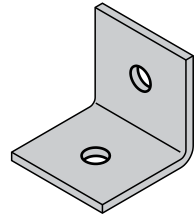

VT
Sayfa / Page: 188

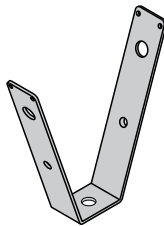

LBP
Sayfa / Page: 189

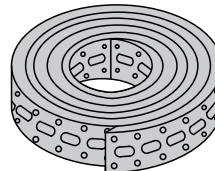

LABP
Sayfa / Page: 189

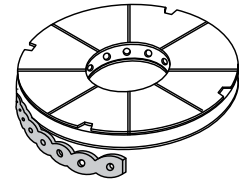

CC-CS
Sayfa / Page: 190

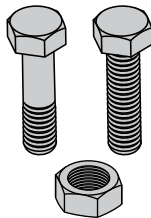

BEL1-BEL2-BEL3
Sayfa / Page: 191

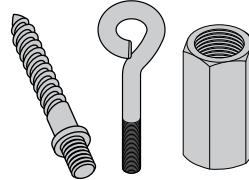

CSY-PRG-CSY1
Sayfa / Page: 191

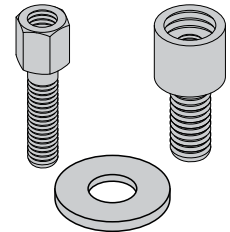

PRY - PR
Sayfa / Page: 190-191

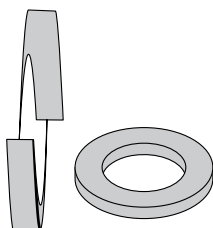

CR
Sayfa / Page: 192-193

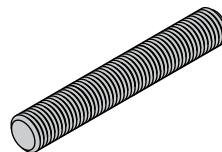

TRB

Gerdirme Turnbuckle

Malzeme / Material :
Dökme Demir / Malleable Iron

Standart Kaplama / Standard Finish :
Elektro galvaniz
Zinc Plated

Hizmet / Service :
Endüstride ve boru sistemlerinde sol ve sağ diş rotların birbirlerine bağlanarak dikey ayar sağlamak için dizayn edilmiştir. / Designed for connection right and left hand rods together and provide for vertical adjustment.

TRB Ölçüler / Dimensions

Kod Code	A mm	B mm	C mm	R	Dizayn Yüğü Design Load kN
TRB.6000-101	100	140	70	M.10	2,0
TRB.6000-102	100	140	70	M.12	3,7
TRB.6000-103	100	140	70	M.14	6,2
TRB.6000-123	150	210	100	M.16	6,2
TRB.6000-124	150	210	100	M.18	8,7
TRB.6000-125	150	210	100	M.20	10,4
TRB.6000-126	150	210	100	M.22	14,0
TRB.6000-127	200	300	100	M.24	18,0
TRB.6000-128	200	300	100	M.27	22,0
TRB.6000-129	200	300	100	M.30	26,0
TRB.6000-130	200	300	100	M.36	34,0
TRB.6000-131	200	300	100	M.42	48,0

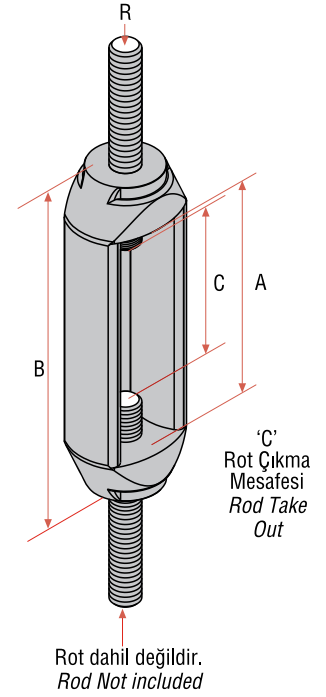

Dökme Demir Maşa Malleable Steel Clevis

Malzeme / Material :
Dökme Demir / Malleable Iron

Standart Kaplama / Standard Finish :
Elektro galvaniz
Zinc Plated

Hizmet / Service :
Endüstride ve boru sistemlerinde eğimin ayarlanması için dizayn edilmiştir.
Designed for the adjustment of the slop of the pipes in industry and pipe systems.

FSC Ölçüler / Dimensions

Kod /Code		Delik Çapı Hole Dia. P mm	D mm	W mm	R mm	H mm	N mm	Dizayn Yüğü Design Load kN
Sağ Diş Right Hand Thread	Sol Diş Left Hand Thread							
FSC.3352	FSC.3352.TD	15	16	25	M.8	90	52	1,4
FSC.3353	FSC.3353.TD	15	16	25	M.10	90	52	2,0
FSC.3354	FSC.3354.TD	15	16	25	M.12	90	52	3,7
FSC.3355	FSC.3355.TD	15	16	25	M.14	90	52	6,2
FSC.3356	FSC.3356.TD	22	22	36	M.16	125	71	8,7
FSC.3357	FSC.3357.TD	22	22	36	M.18	125	71	10,4
FSC.3358	FSC.3358.TD	22	22	36	M.20	125	71	14,0
FSC.3359	FSC.3359.TD	32	32	48	M.24	150	76	18,0
FSC.3360	FSC.3360.TD	32	32	48	M.27	150	76	22,0
FSC.3361	FSC.3361.TD	32	32	48	M.30	150	76	26,4
FSC.3362	FSC.3362.TD	49	49	74	M.36	230	117	32,1
FSC.3363	FSC.3363.TD	49	49	74	M.42	230	117	40,5
FSC.3364	FSC.3364.TD	49	49	74	M.48	230	117	60,2
FSC.3365	FSC.3365.TD	49	49	74	M.52	230	117	80,1

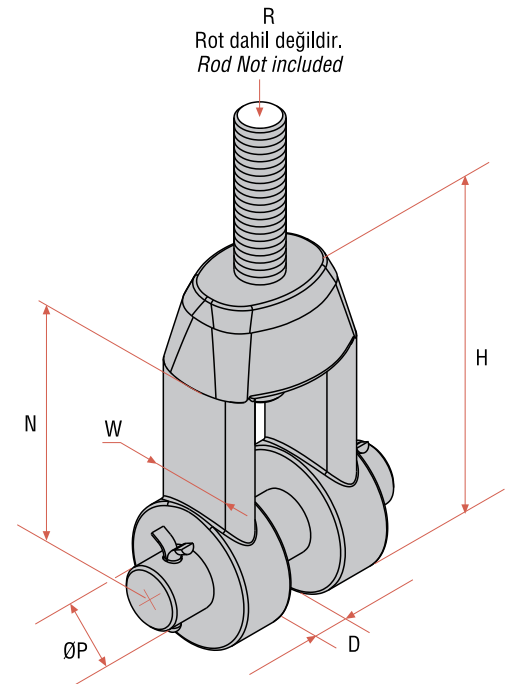

FSC

Kaynaksız Göz Somun Weldless Eye Nut

Malzeme / Material :
Dökme Demir / Malleable Iron

Standart Kaplama / Standard Finish :
Elektro galvaniz
Zinc Plated

Hizmet / Service :
Yüksek sıcaklıktaki boru hatlarında kullanılmak üzere dizayn edilmiştir.
Designed for to use on high temperature piping installations.

MCDH Ölçüler / Dimensions

Kod Code	d	W mm	L mm	N mm	Dizayn Yüklü Design Load kN
MCDH.6008	M.8	17	79	45	2,7
MCDH.6010	M.10	17	79	45	2,7
MCDH.6012	M.12	17	79	45	6,0
MCDH.6016	M.16	25	101	55	13,0
MCDH.6020	M.20	29	125	65	18,0
MCDH.6024	M.24	35	154	80	26,0
MCDH.6030	M.30	42	181	90	60,0
MCDH.6036	M.36	47	202	95	90,0
MCDH.6042	M.42	52	229	105	120,0
MCDH.6048	M.48	62	258	120	160,0

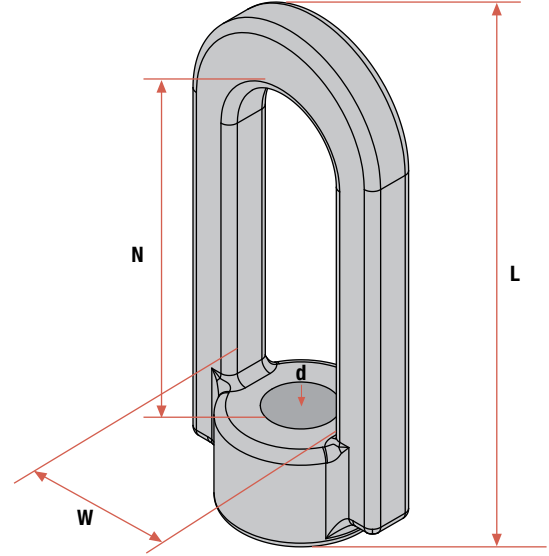

TRB - FSC - MCDH Uygulama Örnekleri / Application Examples

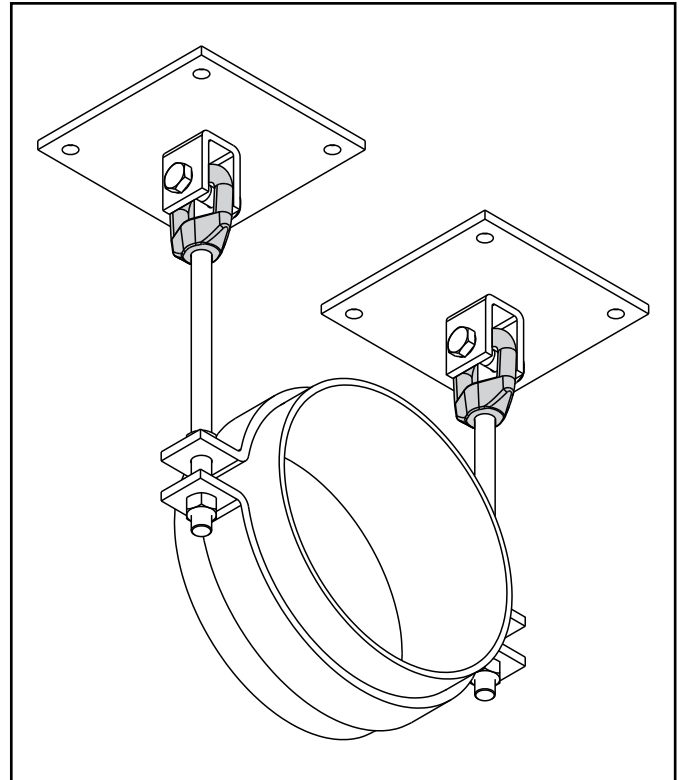
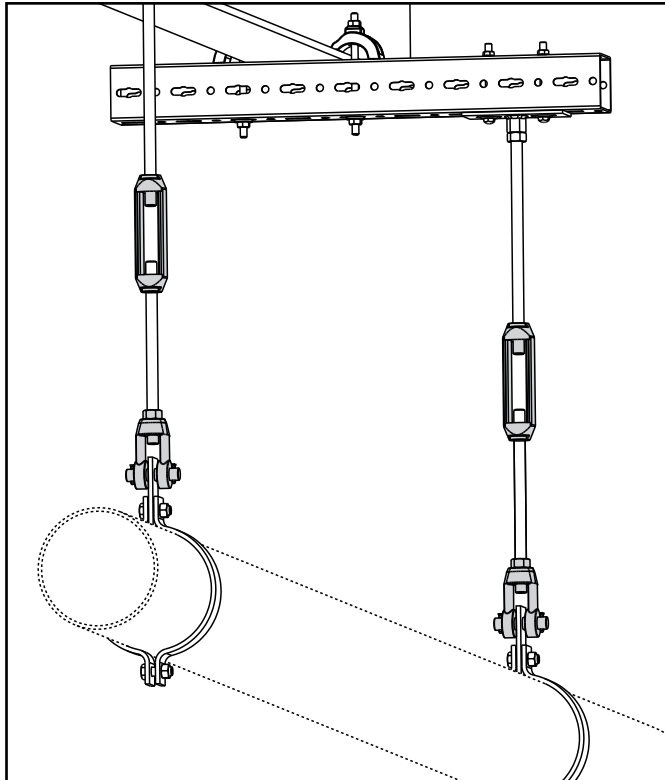

CRAP

Betona Rot Montaj Plakası Concrete Rod Attachment Plate

Malzeme / Material :
Çelik / Steel

Standart Kaplama / Standard Finish:
Elektro galvaniz
Zinc Plated

Hizmet / Service : Dikey ayarlama gerektiği durumlarda beton tavanlara yapısal bağlantıdır. Genelde rot ve somun ile kullanılır.
Structural attachment to concrete ceiling where vertical adjustment is desired. Normally used with threaded rod and nut.

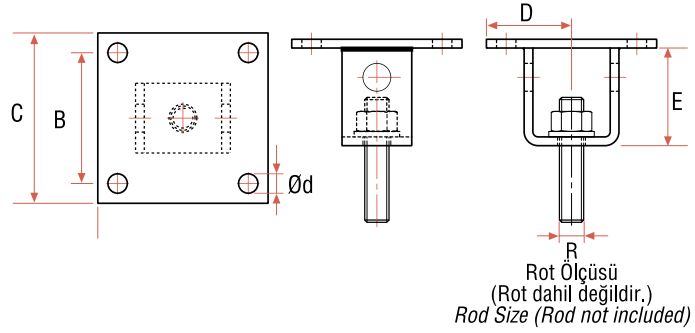
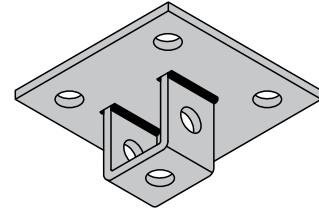

CRAP Ölçüler / Dimensions

Kod Code	R	B mm	C mm	D mm	E mm	Ød mm	Dizayn Yüğü Design Load kN
CRAP.5415	M.10	200	250	125	73	14	3,20
CRAP.5416	M.12	200	250	125	73	14	6,00
CRAP.5417	M.16	200	250	125	73	14	9,50
CRAP.5418	M.20	200	250	125	80	18	14,3
CRAP.5419	M.22	200	250	125	108	18	19,9
CRAP.5420	M.24	200	300	150	114	20	26,2
CRAP.5421	M.27	200	300	150	121	24	33,1
CRAP.5422	M.30	200	300	150	127	24	42,2
CRAP.5423	M.36	200	300	150	165	28	61,3

CRBP

Betona Montaj Plakası Concrete Attachment Plate

Malzeme / Material :
Çelik / Steel

Standart Kaplama / Standard Finish :
Elektro galvaniz
Zinc Plated

Hizmet / Service : Dikey ayarlama gerektiği durumlarda beton tavanlara yapısal bağlantıdır. Genelde rot ve somun ile kullanılır.
Structural attachment to concrete ceiling where vertical adjustment is desired. Normally used with threaded rod and nut.

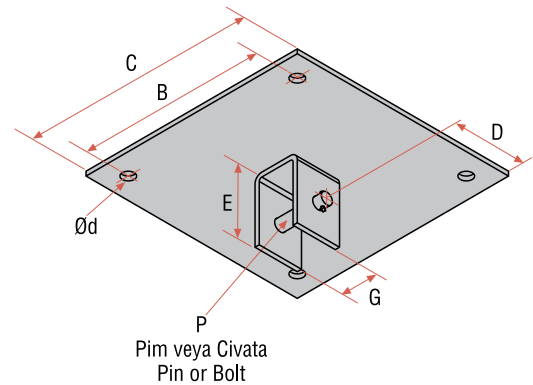

CRBP Ölçüler / Dimensions

Kod Code	P	B mm	C mm	D mm	E mm	Ød mm	G mm	Dizayn Yüğü Design Load kN
CRBP.6415	M.12	200	250	125	73	14	32	3,20
CRBP.6416	M.16	200	250	125	73	14	32	6,00
CRBP.6417	M.20	200	250	125	73	14	32	9,50
CRBP.6418	M.22	200	250	125	80	18	38	14,3
CRBP.6419	M.24	200	250	125	108	18	50	19,9
CRBP.6420	M.27	200	300	150	114	20	50	26,2
CRBP.6421	M.30	200	300	150	121	24	70	33,1
CRBP.6422	M.36	200	300	150	127	24	75	42,2
CRBP.6423	M.42	200	300	150	165	28	90	61,3

CSLP

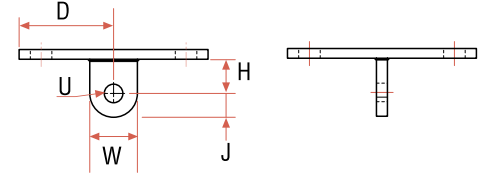
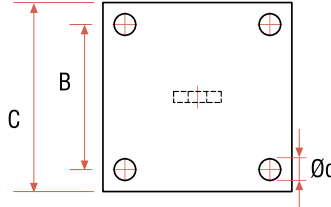
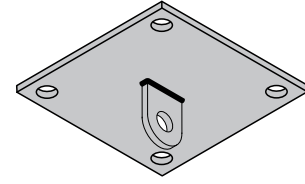
Tek Kulplu Beton Plakası
Concrete Single Lug Plate**Malzeme / Material:**
Çelik / Steel**Standart Kaplama / Standard Finish :**
Elektro galvaniz
Electro Plated Zinc**Hizmet / Service :**
Beton tavanlara bağlantı olarak tasarlanmıştır.
Designed for attachment to concrete ceilings.**CSLP**
Ölçüler / Dimensions

Kod Code	R	B mm	C mm	D mm	Ød mm	H mm	J mm	U mm	W mm	Dizayn Yüğü Design Load kN
CSLP 5444	M.12	200	250	125	15	38	32	16	65	6,0
CSLP 5445	M.16	200	250	125	15	38	32	20	65	9,6
CSLP 5446	M.20	200	250	125	18	38	32	22	65	14,4
CSLP 5447	M.22	200	250	125	18	50	32	24	65	19,9
CSLP 5448	M.24	200	300	150	21	50	38	28	76	26,2
CSLP 5449	M.27	200	300	150	24	76	38	32	76	33,1
CSLP 5450	M.30	200	300	150	24	76	50	34	102	42,2
CSLP 5451	M.36	200	300	150	28	76	64	42	127	61,4

Tek Kulplu Plaka
Single Lug Plate**Malzeme / Material :**
Çelik / Steel**Standart Kaplama / Standard Finish :**
Elektro galvaniz
Electro Plated Zinc**Hizmet / Service :**
Çelik yapı elemanlarına bağlantı için tasarlanmıştır.
Designed for attachment to structural steel.

PLSP

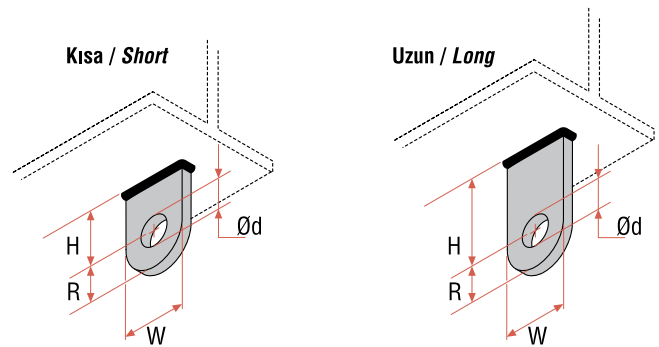
**PLSP**
Ölçüler / Dimensions

Kod / Code		Ød mm	R mm	H		W mm	Dizayn Yüğü Design Load kN
Kısa / Short	Uzun / Long			Kısa / Short mm	Uzun / Long mm		
PLSP.5418	PLSP.6418	18	32	38	76	63	6,00
PLSP.5420	PLSP.6420	20	32	38	76	63	9,60
PLSP.5424	PLSP.6424	24	32	38	76	63	14,4
PLSP.5428	PLSP.6428	28	32	51	76	63	19,9
PLSP.5432	PLSP.6432	32	38	51	76	76	26,2
PLSP.5436	PLSP.6436	36	38	76	102	76	33,1
PLSP.5438	PLSP.6438	38	51	76	102	102	42,2
PLSP.5444	PLSP.6444	44	64	76	114	127	61,4
PLSP.5450	PLSP.6450	50	64	76	114	127	82,7
PLSP.5460	PLSP.6460	60	76	102	114	152	109,5

Kiriş Kaynak Bağlantı Elemanı Welding Beam Attachment

Malzeme / Material :
Çelik / Steel

Standart Kaplama / Standard Finish:
Elektro galvaniz
Zinc Plated

Ağır yük ve büyük çaplı askı rotlarının çelik yapı elemanlarının alt flanşlarına bağlantısı için tasarlanmıştır.
Designed for attaching hanger rod to bottom of structural steel where heavy load and large hanger rod sizes are required. Can be welded in place in either the upright or inverted position.

IUL Ölçüler / Dimensions

Kod Code	R	K mm	B mm	C mm	Ød mm	E mm	Dizayn Yüğü Design Load kN	
							350°C	400°C
IUL.6010	M.10	M.12	72	22	14	32	3,25	2,54
IUL.6012	M.12	M.16	72	22	18	32	6,00	4,70
IUL.6016	M.16	M.20	72	22	22	32	9,61	7,52
IUL.6020	M.20	M.22	78	28	24	38	14,37	11,25
IUL.6022	M.22	M.24	108	32	30	50	19,93	15,60
IUL.6024	M.24	M.27	113	38	32	50	26,24	20,55
IUL.6027	M.27	M.32	113	38	34	70	33,14	25,93
IUL.6030	M.30	M.36	126	51	38	76	42,25	33,09
IUL.6036	M.36	M.42	163	63	44	89	61,38	48,07
IUL.6042	M.42	M.48	195	70	50	95	82,73	64,79
IUL.6048	M.48	M.56	207	82	60	95	109,42	87,29

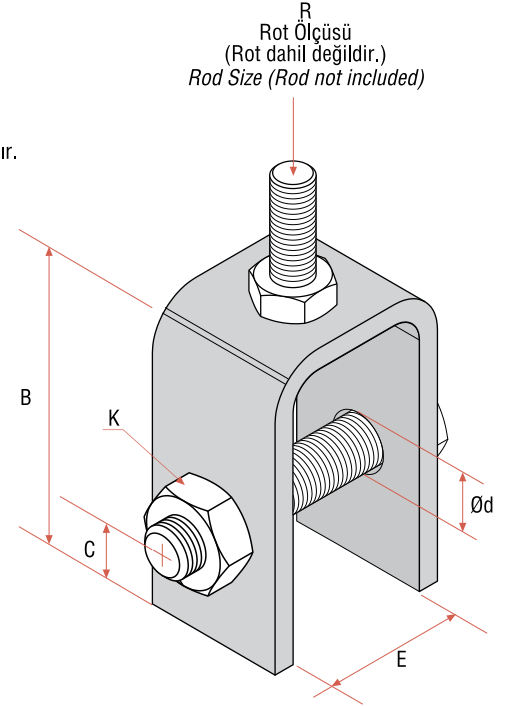

Tavana bağlama parçası Upper Attachment

Malzeme / Material :
Çelik / Steel

Standart Kaplama / Standard Finish:
Elektro galvaniz
Zinc Plated

Hizmet / Service :
Çelik yapıların askı elemanı olarak kullanılması için dizayn edilmiştir.
Designed for to be used in Steel construction structures as a suspension material.

LUP Ölçüler / Dimensions

Kod Code	R mm	B mm	C mm	D mm	Ød mm	Ayar Mesafesi Adjustment	Dizayn Yüğü Cıvata ile Design Load With bolts kN
						H mm	
LUP.7810	M.10	100	79	86	11	70	3,25
LUP.7812	M.12	136	105	92	14	70	6,00
LUP.7816	M.16	150	114	94	18	68	9,61
LUP.7820	M.20	168	117	121	23	89	14,37
LUP.7822	M.22	184	133	125	23	90	19,93

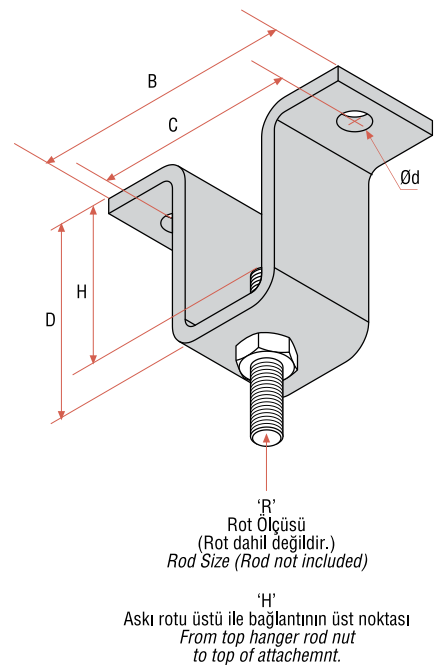

AYBF

Ağır Yük Tavan Flanşı Heavy Duty Ceiling Flange

Malzeme / Material :
Çelik / Steel

Standart Kaplama / Standard Finish:
Elektro galvaniz
Zinc Plated

Hizmet / Service :
Destek veya askı rotalarını profile, tavana veya yapı profillerine montaj etmek için dizayn edilmiştir.
Designed for attaching a hanger or support rod to beam, ceiling or strut channel.

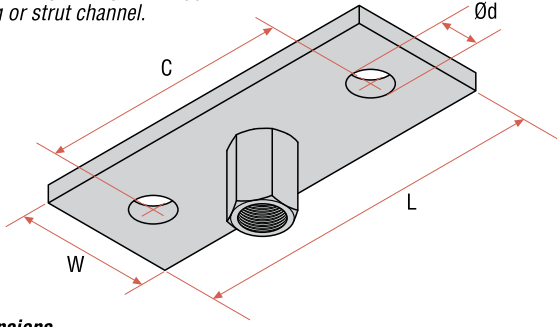

AYBF Ölçüler / Dimensions

Kod Code	R	L mm	W mm	Ød mm	C mm	Dizayn Yüğü Design Load kN
AYBF.5413.01	M.10	110	50	11	65	3,50
AYBF.5413.02	M.12	152	50	13	100	5,20
AYBF.5413-001	M.16	152	50	13	100	9,71
AYBF.5413-002	M.20	152	50	18	100	14,37
AYBF.5413-003	M.22	203	76	18	125	19,93
AYBF.5413-004	M.24	203	76	18	125	26,24

LPK

Plaka Plate

Malzeme / Material :
Çelik / Steel

Standart Kaplama / Standard Finish:
Elektro galvaniz
Zinc Plated

Hizmet / Service : Montaj plakası olarak tasarlanmıştır.
Designed for unstation plate.

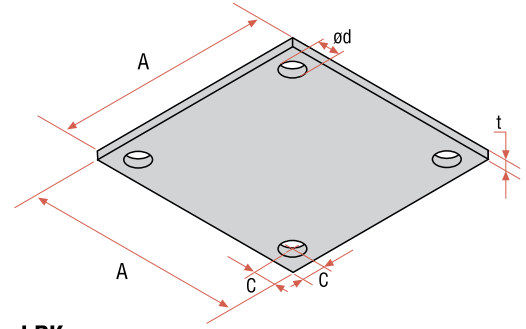

LPK Ölçüler / Dimensions

Kod Code	Ød mm	t mm	A mm	C mm
LPK.1508	11	6	100	25
LPK.1509	11	8	150	25
LPK.2011	13	10	200	25
LPK.2514	23	12	250	35
LPK.3017	23	15	300	35

Kiriş Yanı Köşe Bağlantısı Side Beam Angle Clip

Malzeme / Material:
Çelik / Steel

Standart Kaplama / Standard Finish :
Elektro galvaniz
Zinc Plated

Hizmet / Service :
Askı rotalarını kiriş yanına veya duvara montaj etmek için dizayn edilmiştir.
Designed for attaching a hanger rod to the side of beams or walls.

YDRB Ölçüler / Dimensions

Kod Code	Ød mm	B mm	W mm	D mm	Dizayn Yüğü Design Load kN
YDRB.5413-020	11	35	50	20	0,80
YDRB.5413-024	11	55	50	32	1,20
YDRB.5413-025	13	55	50	32	2,40
YDRB.5413-026	17	75	50	45	4,00
YDRB.5413-027	21	75	75	45	6,00
YDRB.5413-028	23	100	100	65	8,20
YDRB.5413-029	27	100	100	65	11,0

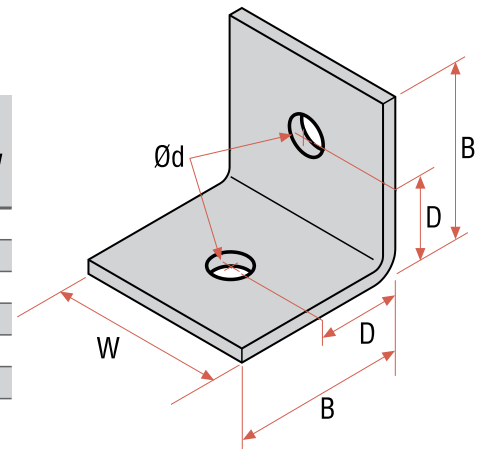

YDRB

Trapez kelepçe Trapeze Decking Hanger

Malzeme / Material :
Çelik / Steel

Standart Kaplama / Standard Finish:
Elektro galvaniz
Zinc Plated

Hizmet / Service :
Trapez çatı elemanlarından askılama için tasarlanmıştır.
Designed for attaching a hanger rod to trapeze deck.

VT Ölçüler / Dimensions

Kod / Code VT	H mm	A mm	E mm	F mm	t x W mm	Ad. / Kutu Pie. / Box	Kg / Kutu Kg / Box
VT.2011	90	97	11	6	2,5 x 25	50	0,10
VTS.3008	90	97	M.8	6	2,5 x 25	50	0,11
VTS.3010	90	97	M.10	6	2,5 x 25	50	0,12
VTL.4008	90	97	8	6	2,5 x 25	50	0,11

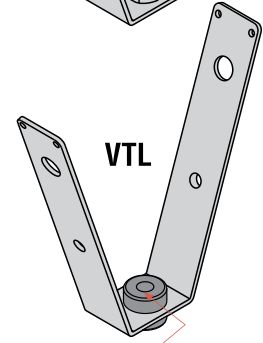
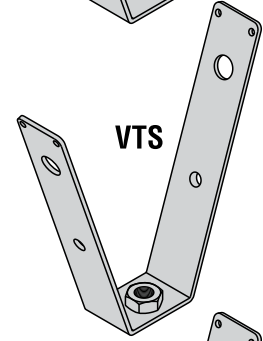
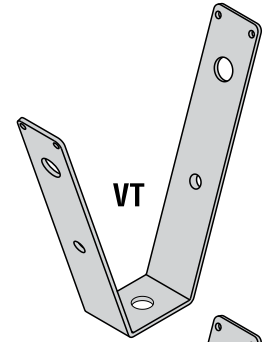
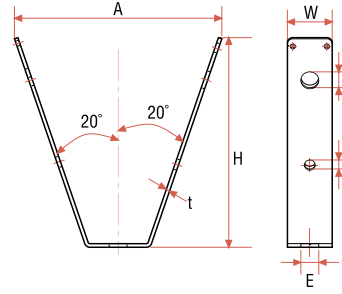

Uygulama Örnekleri / Application Examples

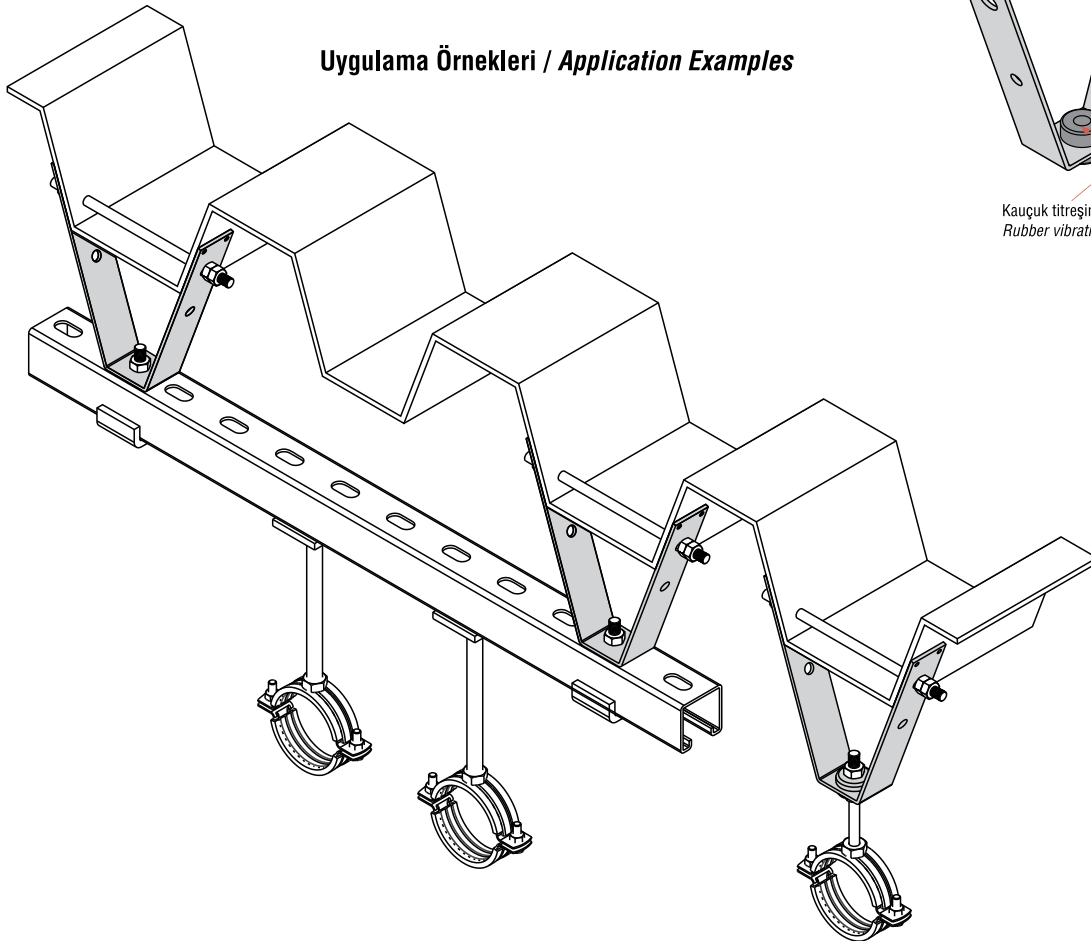

Kauçuk titreşim alıcı
Rubber vibration absorber

Perfore Bant Perforated Band

Malzeme / Material :
Çelik / Steel

Standart Kaplama / Standard Finish:
Sendzimir Galvaniz / Sendzimir Galvanized

LBP Ölçüler / Dimensions

Kod Code	Tip Type	W x t mm
LBP.5413-120	LBP-2	25 x 0,8

Dizayn yükü/Design load : 0,50 kN

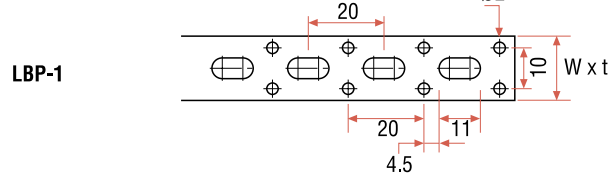

Dizayn yükü/Design load : 0,75 kN

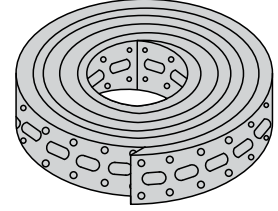
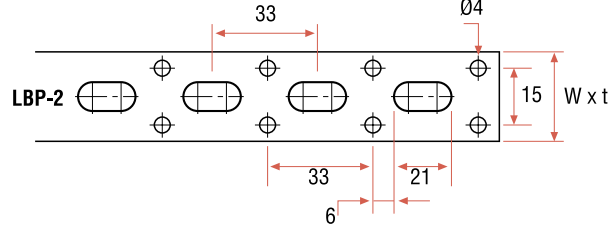

LABP Ölçüler / Dimensions

Kod Code	Tip Type	W x t mm	ØD mm	Dizayn Yüğü Design Load kN
LABP.5413-142	LABP-3	26 x 1,0	8	1,00
LABP.5413-141	LABP-2	17 x 0,8	7	0,75

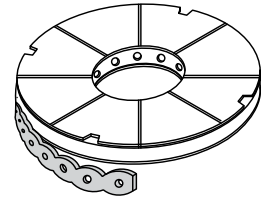
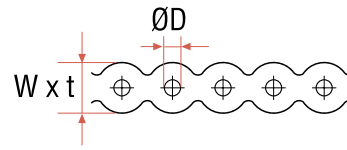

Uygulama Örnekleri / Application Examples

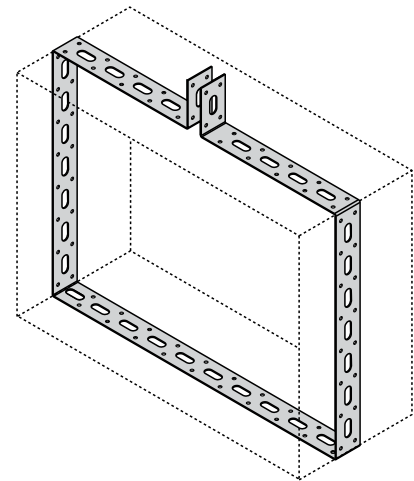
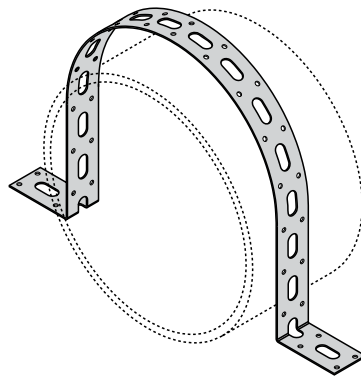
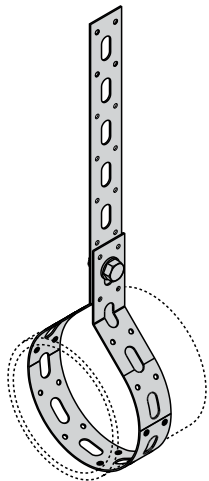

Altı Köşe Civata Hexagon Head Bolt

CC

Malzeme / Material : Çelik / Steel

Standart Kaplama / Standard Finish : Elektrogalvaniz / Zinc Plated

CC Ölçüler / Dimensions

Kod Code	Civata Ölçüsü Bolt Size D x L mm
CC.800825	M.8 x 25
CC.800850	M.8 x 50
CC.801025	M.10 x 25
CC.801035	M.10 x 35
CC.801050	M.10 x 50
CC.801225	M.12 x 25
CC.801235	M.12 x 35
CC.801250	M.12 x 50
CC.801635	M.16 x 35
CC.801650	M.16 x 50
CC.801670	M.16 x 70
CC.802040	M.20 x 40

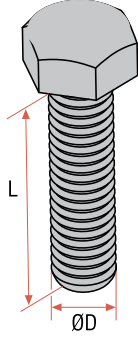

DIN 933
ISO 4017

Malzeme Özellik Sınıfları
Material Class :
8.8

Altı Köşe Civata Hexagon Head Bolt

EPSS

Malzeme / Material : Çelik / Steel

Standart Kaplama / Standard Finish : Sıcak Daldırma galvaniz/Hot-Dip Galvanized

EPSS Ölçüler / Dimensions

Kod Code	Civata Ölçüsü Bolt Size D x L mm
EPSS.21214	M.12 x 140
EPSS.21217	M.12 x 170
EPSS.22016	M.20 x 160
EPSS.22024	M.20 x 240

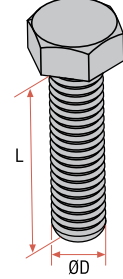

DIN 933
ISO 4017

Malzeme Özellik Sınıfları
Material Class :
8.8

Altı Köşe Somun Hexagon Head Nut

CS

Malzeme / Material : Çelik / Steel

Standart Kaplama / Standard Finish : Elektrogalvaniz / Zinc Plated

CS Ölçüler / Dimensions

Kod Code	Somun Ölçüsü / Nut Size D mm
CS.8808	M.8
CS.8810	M.10
CS.8812	M.12
CS.8816	M.16
CS.8820	M.20

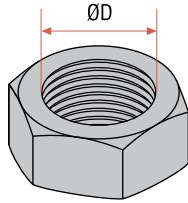

DIN 934

Malzeme Özellik Sınıfları
Material Class :
8

Altı Köşe Flanşlı Somun Hexagonal Flange Nut

EPCS

Malzeme / Material : Çelik / Steel

Standart Kaplama / Standard Finish : Sıcak Daldırma galvaniz/Hot-Dip Galvanized

EPCS Ölçüler / Dimensions

Kod Code	Somun Ölçüsü / Nut Size D mm
EPCS.0212	M.12
EPCS.0220	M.20



DIN 6923

Düz Pul Flat Washer

PR

Malzeme / Material : Çelik / Steel

Standart Kaplama / Standard Finish : Sıcak Daldırma galvaniz/Hot-Dip Galvanized

PR Ölçüler / Dimensions

Kod Code	Anma Çapı Thread Size mm	Ød1 mm	Ød2 mm	tmin mm
PR.0212	M.12	13.0	24.0	2.3
PR.0220	M.20	21.0	37.0	2.7

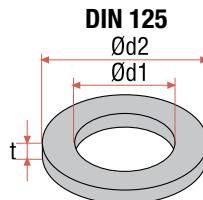

DIN 125

Çeşitli Dişli Bağlantı Elemanları Various Other Connection & Threaded Accessories

Malzeme / Material : Çelik / Steel

Standart Kaplama / Standard Finish : Elektrogalvaniz / Zinc Plated

BEL1 Trifon / Threaded Lag Screw

Kod Code	Rot Ölçüsü Rod Size R x L mm	b1 mm	b2 mm
BEL1.5106	M.8 x 50	15	30
BEL1.5107	M.8 x 65	15	45
BEL1.5108	M.10 x 80	20	50

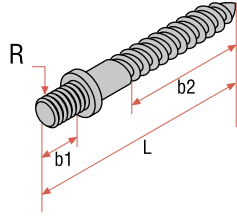

BEL2 Göz Rot-2 / Linked Eye Rod-2

Kod Code	A mm	Rot Ölçüsü Rod Size R	L mm	Y mm	H mm
BEL2.5410	30	M.8	160	100	200
BEL2.5411	40	M.10	210	100	250
BEL2.5412	50	M.12	240	100	300
BEL2.5413	50	M.16	290	100	350

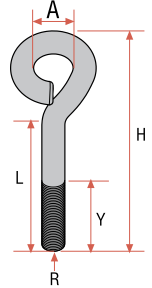

BEL3 UZatma Manşonu / Steel Rod Coupling

Kod Code	R	L mm	Dizayn Yüğü Design Load kN
BEL3.5108	M.8	40	1,33
BEL3.5110	M.10	40	2,11
BEL3.5112	M.12	40	3,25
BEL3.5116	M.16	40	6,00
BEL3.5120	M.20	40	9,61
BEL3.5124	M.24	40	14,37

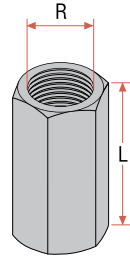

CSY Adaptör Cıvata / Adaptor Bolt

Kod Code	R1 x R2	L1 mm	L2 mm
CSY.8320	M.8 x M.8	20	40
CSY.8321	M.8 x M.10	20	40
CSY.8322	M.10 x M.8	20	40
CSY.8323	M.10 x M.10	20	40
CSY.8324	M.10 x M.12	20	40
CSY.8325	M.12 x M.8	25	40
CSY.8326	M.12 x M.10	25	40
CSY.8327	M.12 x M.12	25	40

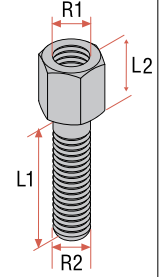

PRG Geniş Düz Pul / Large Size Washer

DIN 9021

Kod Code	Anma Çapı Thread Size mm	ød1 mm	ød2 mm	t mm
PRG.8808	M.8	8,4	24,0	2,5
PRG.8810	M.10	10,5	30,0	3,0
PRG.8812	M.12	13,0	37,0	3,0
PRG.8816	M.16	17,0	50,0	4,0

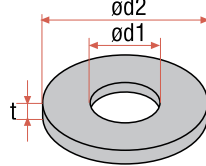

CSY1 Adaptör Cıvata / Adaptor Bolt

Kod Code	R1 x R2	ød mm	L1 mm	L2 mm
CSY1.8347	M.8 x M.10	15	30	40
CSY1.8348	M.10 x M.12	18	30	40
CSY1.8349	M.12 x M.16	20	40	40
CSY1.8350	M.16 x M.20	27	40	40

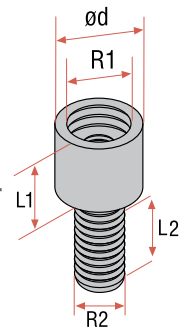

PRY Yaylı Rondela / Spring Lock Washer

DIN 127

Kod Code	Anma Çapı Thread Size mm	D1 mm	D2 mm	t mm
PRY.8808	M.8	8,5	14,8	1,9
PRY.8810	M.10	10,5	18,1	2,1
PRY.8812	M.12	12,5	21,1	2,4
PRY.8816	M.16	16,5	27,4	3,3
PRY.8820	M.20	20,5	33,6	3,8

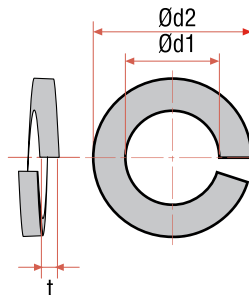

PR Düz Pul / Flat Washer

DIN 125

Kod Code	Anma Çapı Thread Size mm	ød1 mm	ød2 mm	t mm
PR.8808	M.8	8,4	16,0	1,4
PR.8810	M.10	10,5	20,0	1,8
PR.8812	M.12	13,0	24,0	2,3
PR.8816	M.16	17,0	30,0	2,7
PR.8820	M.20	21,0	37,0	2,7

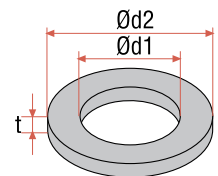

Dişli Saplamlar Thread Stud

Malzeme / Material :
Çelik / Steel

Malzeme Özellik Sınıfları / Material Class: 4.6

Standart Kaplama / Standard Finish :
Elektro galvaniz
Zinc Plated

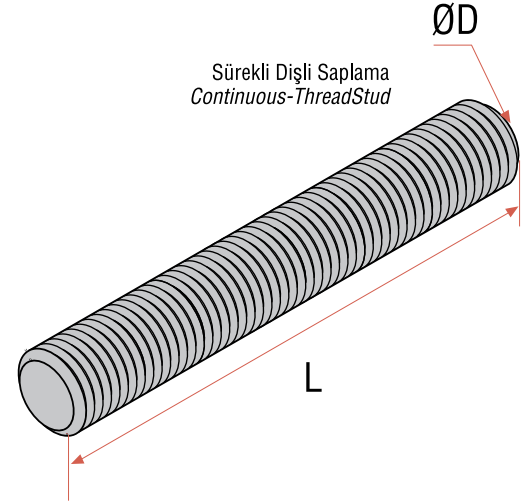

CR Ölçüler / Dimensions

Kod Code	Saplama Ölçüsü Stud Size D x L mm	Ambalaj Adedi Package Quantity	Ambalaj Ağırlığı Package Weight kg	Dizayn Yüğü Design Load kN
CR.060060	M.6 x 60	2000	22,40	4,56
CR.060080	M.6 x 80	2000	29,80	4,56
CR.080035	M.8 x 35	2000	24,20	8,15
CR.080055	M.8 x 55	1200	22,80	8,15
CR.080100	M.8 x 100	600	20,82	8,15
CR.100035	M.10 x 35	1600	37,28	12,87
CR.100055	M.10 x 55	800	24,48	12,87
CR.100100	M.10 x 100	400	22,24	12,87
CR.120080	M.12 x 80	300	19,20	18,55
CR.120100	M.12 x 100	300	24,00	18,55
CR.120140	M.12 x 140	300	33,60	18,55
CR.140100	M.14 x 100	50	5,50	25,41
CR.140140	M.14 x 140	50	7,70	25,41
CR.160100	M.16 x 100	50	7,25	33,34
CR.160140	M.16 x 140	50	10,10	33,34
CR.160200	M.16 x 200	50	14,50	33,34
CR.180140	M.18 x 140	20	5,40	42,35
CR.180200	M.18 x 200	20	7,50	42,35
CR.200150	M.20 x 150	20	6,80	52,12
CR.200200	M.20 x 200	20	9,00	52,12

Dişli Askı Rotları
Thread Hanging Rods**Malzeme / Material :**
Çelik / Steel

Malzeme Özellik Sınıfları / Material Class: 4.6

Standart Kaplama / Standard Finish :
Elektro galvaniz
Zinc Plated**CR Ölçüler / Dimensions**

Kod Code	Saplama Ölçüsü Stud Size D x L mm	Ambalaj Adedi Package Quantity	Ambalaj Ağırlığı Package Weight kg	Dizayn Yüğü Design Load kN
CR.061000	M.6 x 1000	100	18,70	4,56
CR.062000	M.6 x 2000	100	37,40	4,56
CR.081000	M.8 x 1000	50	17,35	8,15
CR.082000	M.8 x 2000	25	17,35	8,15
CR.101000	M.10 x 1000	25	13,90	12,87
CR.102000	M.10 x 2000	20	22,8	12,87
CR.121000	M.12 x 1000	25	20,00	18,55
CR.122000	M.12 x 2000	15	24,00	18,55
CR.141000	M.14 x 1000	20	22,00	25,41
CR.142000	M.14 x 2000	20	44,00	25,41
CR.161000	M.16 x 1000	10	14,50	33,34
CR.162000	M.16 x 2000	10	29,00	33,34
CR.181000	M.18 x 1000	10	18,50	42,35
CR.182000	M.18 x 2000	10	37,00	42,35
CR.201000	M.20 x 1000	5	11,25	52,12
CR.202000	M.20 x 2000	5	22,50	52,12
CR.221000	M.22 x 1000	5	13,30	63,25
CR.222000	M.22 x 2000	5	26,60	63,25
CR.241000	M.24 x 1000	5	16,30	75,46
CR.242000	M.24 x 2000	5	32,60	75,46
CR.271000	M.27 x 1000	5	21,50	95,79
CR.272000	M.27 x 2000	5	43,00	95,79
CR.301000	M.30 x 1000	5	26,50	118,54
CR.302000	M.30 x 2000	5	53,00	118,54
CR.361000	M.36 x 1000	5	39,50	170,74
CR.362000	M.36 x 2000	5	79,00	170,74
CR.421000	M.42 x 1000	5	48,50	233,11
CR.422000	M.42 x 2000	5	97,00	233,11

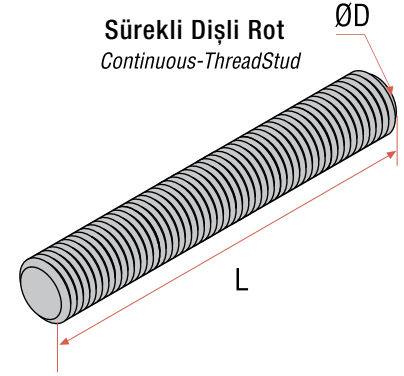

Eğilme Dizayn Yüğü / Bending Design Load(*)				
Uzunluk L mm	M8 F(kN)	M10 F(kN)	M12 F(kN)	M16 F(kN)
50	0,10	0,20	0,34	0,87
100	0,04	0,10	0,17	0,43
150	0,02	0,05	0,11	0,29
200	0,01	0,08	0,06	0,21
250		0,02	0,04	0,15
300		0,01	0,03	0,09
350			0,02	0,07
400			0,01	0,05

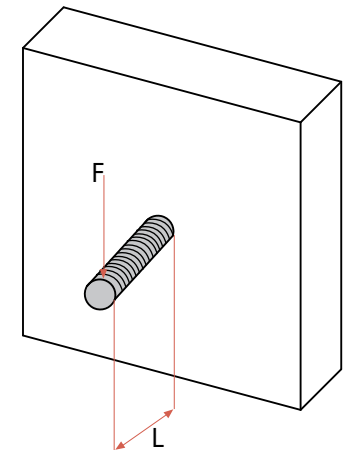
(*)Emniyet Faktörü / Safety Factor: 1.5
Max. Sehım / Max. Deflection f=L/150

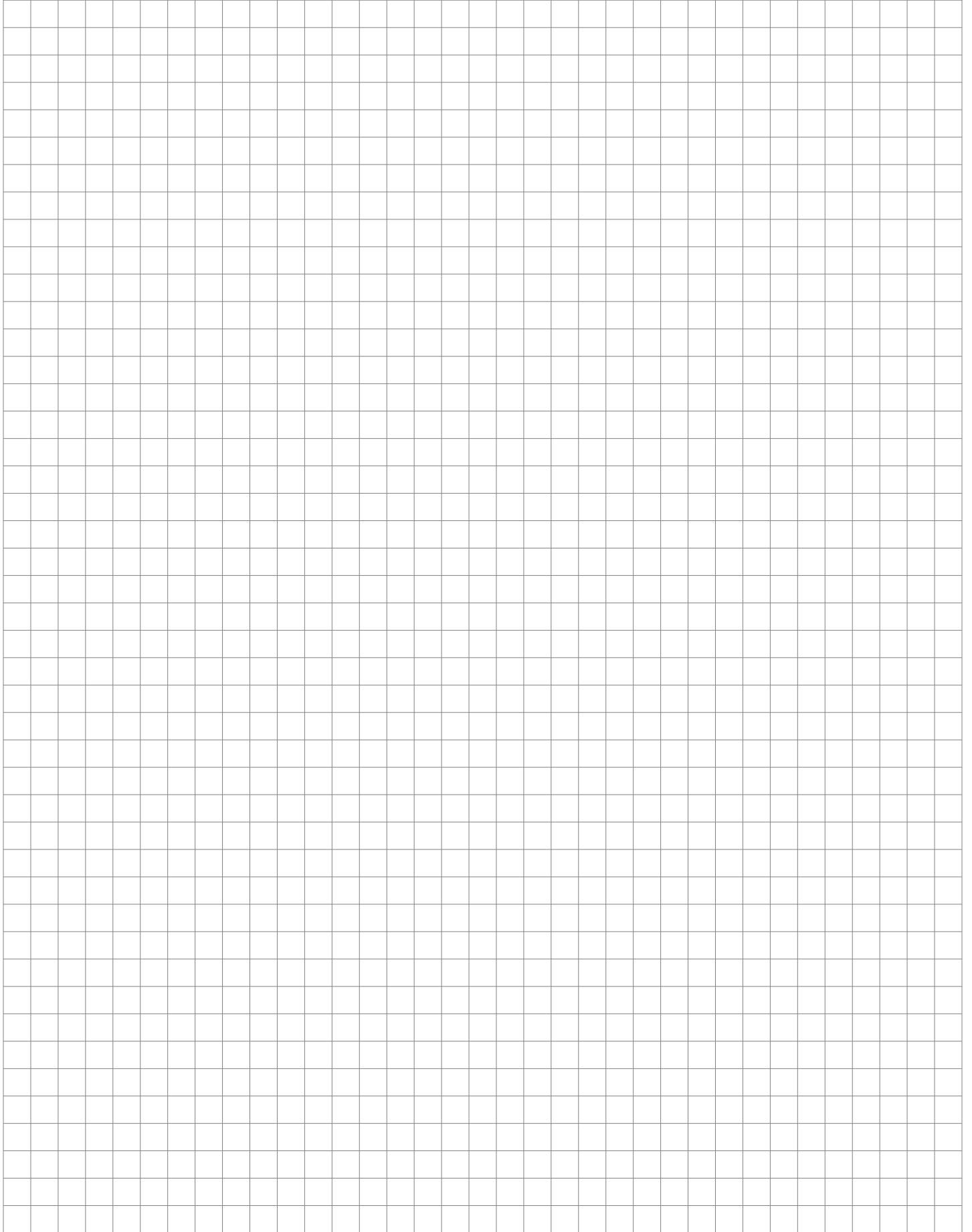



LINK

we link the world



LINK YAPI SANAYİ ve TİCARET A.Ş.

G.O.S.B. 1000. Sokak No: 1016 Çayırova / Kocaeli
T: +90 444 54 65 F: +90 262 751 33 23
info@linkyapi.com.tr

Tepe Prime C Blok No: 53 Eskişehir Devlet Yolu 9. km
Çankaya / Ankara
T: +90 312 220 40 24-25 F: +90 312 220 40 26



www.linkyapi.com.tr